

CLIP top 120°+ hinges

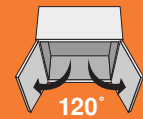

CLIP top/CLIP



Features

- 120° opening angle
- For larger overlays (max. 21mm)
- 3-dimensional adjustment
- All metal hinge, nickel plated
- Available INSERTA tool free attachment

Cover caps
Mounting plates
BLUMOTION for doors

page 27
pages 43-47
page 73

Minimum Reveal

Minimum reveal table						
1.2	1.7	2.0	2.4	3.3	3	
1.2	1.7	2.0	2.3	3.1	4	
1.1	1.6	1.9	2.2	3.0	5	
1.1	1.6	1.9	2.2	2.9	6	
16	18	19	20	22	B	
T Door thickness					B Bore	

Cross reference the door thickness and bore distance to assure that doors won't bind when opened.

For door thickness greater than 22mm trial application recommended or use Thick door hinge (page 16).

Frame cabinet applications

Overlay door

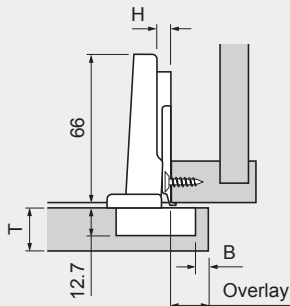

Panel cabinet applications

Overlay door

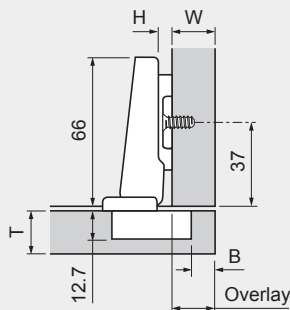

Straight arm hinges

	Self close	Free swing
Screw on	73T5550	72T5550
Press-in	73T5580	72T5580
Expando	73T558E	-
INSERTA	73T5590	72T5590

Overlay table

0	16	17	18	19	9.5	19
3	13	14	15	16	12.5	22
4.5	11.5	12.5	13.5	14.5	14	23.5
6	10	11	12	13	15.5	25
9	7	8	9	10	18.5	28
H	3	4	5	6	P	S
Plate	B Bore distance				Clearance	

NOTE:

4.5 plate only available for face frame, 9 plate only available for panel cabinets

13 fixed distance

Straight arm hinges

	Self close	Free swing
Screw on	73T5550	72T5550
Press-in	73T5580	72T5580
Expando	73T558E	-
INSERTA	73T5590	72T5590

Reveal table

Reveal table					Twin overlay	
9	2	-	-	-	16	18.5
	5	3	1	-	19	28
H	3	4	5	6	W	P S
Plate	B Bore distance				Clearances	

4 fixed distance

Twin overlay doors

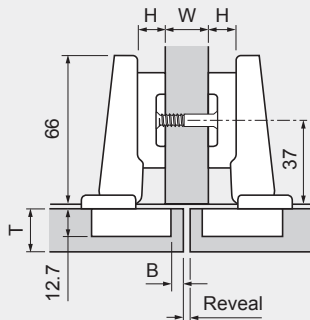

Building both frame and panel cabinets

Frame

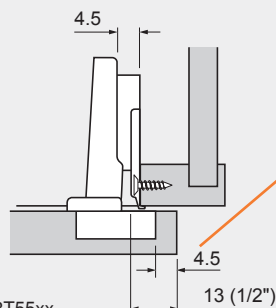

Hinge: 73T55xx
Plate: 175H6040

Panel

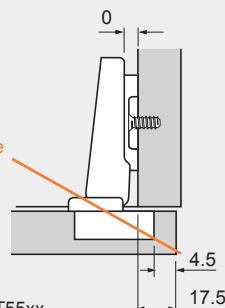

Hinge: 73T55xx
Plate: any 0 plate

Same boring distance

The most common overlays for frame and panel cabinets can be achieved by using the same machine setting for hinge cup boring.

- Boring **ALL** doors at 4.5mm
- 13mm (1/2") overlay on frame cabinets and
 - 17.5mm overlay on panel cabinets

can be achieved using hinge/plate combinations to the left.

Advantages:

- Only one machine setting for boring all doors (4.5mm)
- Same hinge used for both applications (73T55xx)

For more information on using this section see page 5.

All dimensions in millimeters (inch equivalents as shown).

Subject to technical modifications without notice. © 2004